



FOR LEASE



2708 Centre Park
DeSoto, Texas

BUILDING B
300,202 SF AVAILABLE

Site Strengths

- 46 Acre Site
- Access from E Centre Park Blvd & E Wintergreen Rd
- Expandable Parking
- Direct Access to I-35
- Full Truck Circulation
- Ability to Secure Truck Courts
- Proximity to Abundant Labor and Area Amenities

Excellent Access

- 0.5 Miles to I-35
- 1.5 Miles to I-20
- 8 Miles to UP Dallas Intermodal
- 7 Miles to I-45
- 8 Miles to FedEx Ground Terminal
- 18 Miles to Dallas Love Field
- 29 Miles to DFW Airport

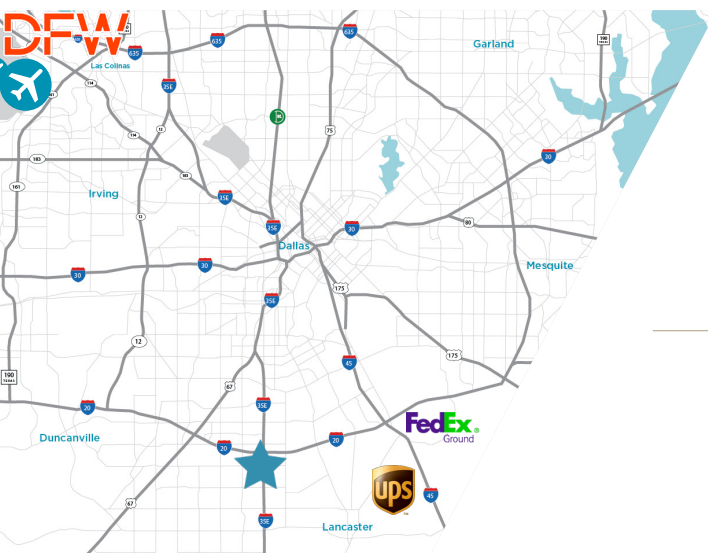

FOR LEASE

TRADE CENTER 20/35

2708 Centre Park
DeSoto, Texas

300,202 SF AVAILABLE

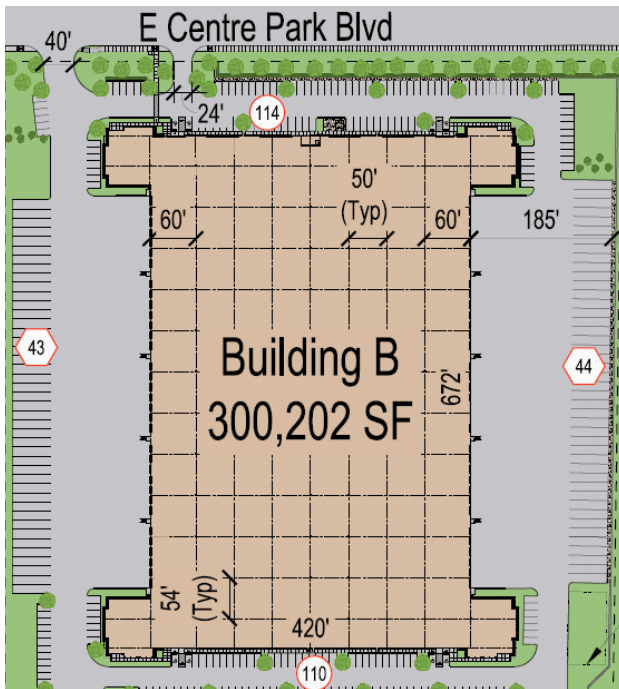

Property Highlights

- 300,202 SF Available
- Clear Height: 36'
- Building Depth: 470'
- Column Spacing: 54' x 50'
- Loading Bay: 60'
- Spec Office Space
- ESFR Sprinkler
- Dock Doors: 64
- Drive-In Doors: 4
- Truck Court: 185'
- Car Parks: 224
- Trailer Parks: 87
- All Interior Walls Painted White

FOR LEASE

TRADE CENTER 20/35

2708 Centre Park
DeSoto, Texas

300,202 SF AVAILABLE

Surrounding Amenities

