



For Lease

Winton Industrial Center

2802 W. Winton Ave | Hayward, CA

±64,916 SF Warehouse/Distribution Space

Property Description

±64,916 SF high image warehouse/distribution corner unit located at the Winton Industrial Center.

Property Features

- ±4,011 SF of office space combined in two separate locations
- Eighteen (18) dock high doors
- Four (4) grade level drive-in doors
- T-5 lighting throughout
- ±22' – ±24' clear height
- ±48' x ±60' typical column spacing
- Skylights throughout
- Fully sprinklered (0.45 GPM/3,000 SF)
- 1/1,000 parking ratio
- 400 amps, 277/480 volts, 3-phase electrical service (subject to verification)
- High image corner unit located at the entrance to the park
- Deliverable August 1, 2022

Call For Pricing

For Lease

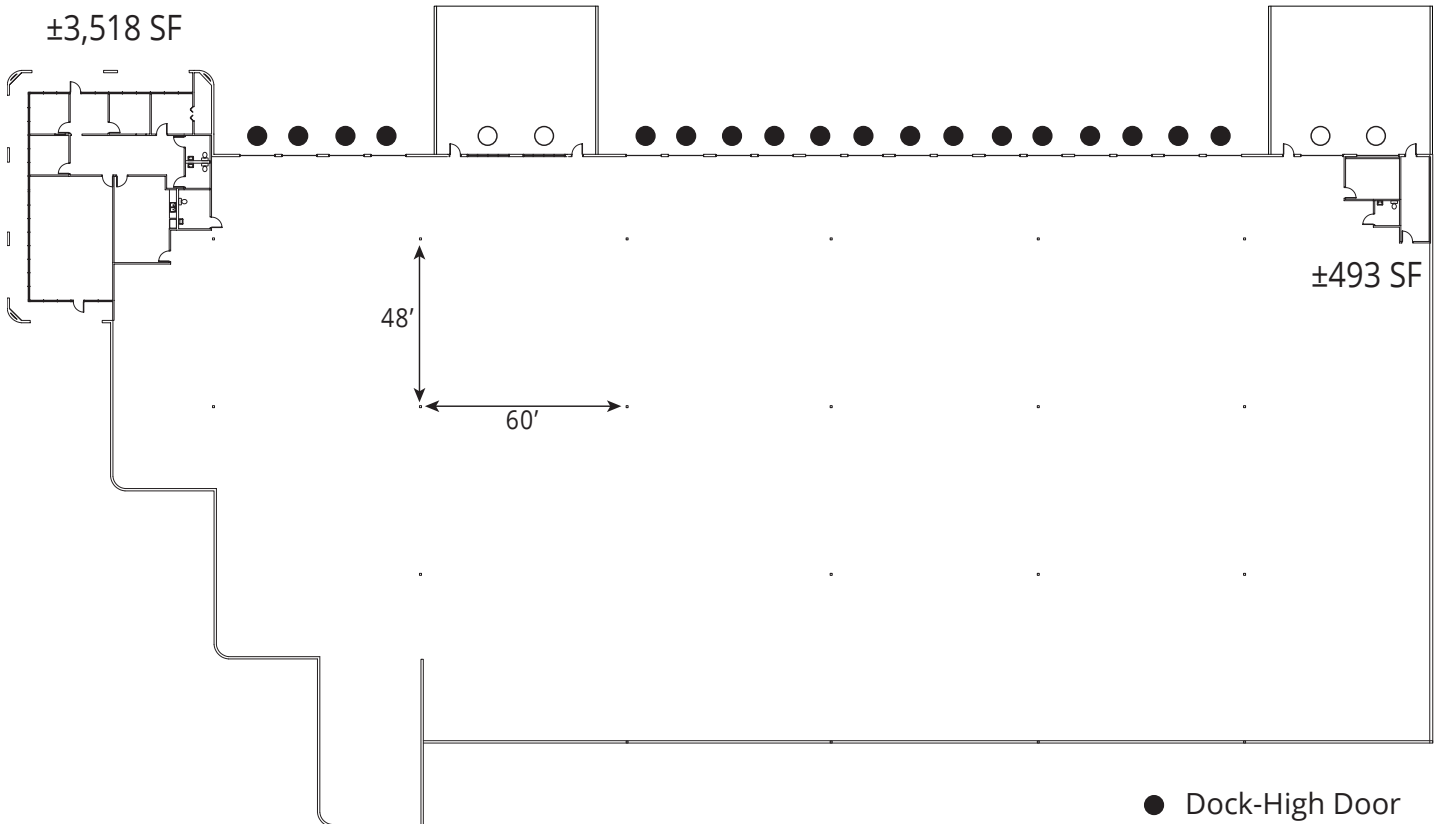

- Dock-High Door
- Grade-Level Door