

For Lease

501 S Elmgrove Building

501 S Elmgrove Street,
Seattle, WA

12,048 SF total

1,280 SF office

6 drive-in loading doors

20' clear height

10 ton and 5 ton bridge crane

Lease rate: \$0.75 PSF, NNN

Freestanding building



Location

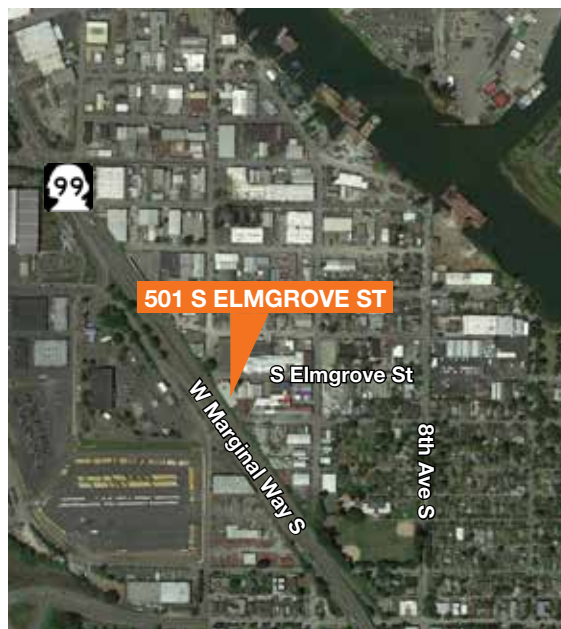

For Lease

501 S Elmgrove Building

SR 599

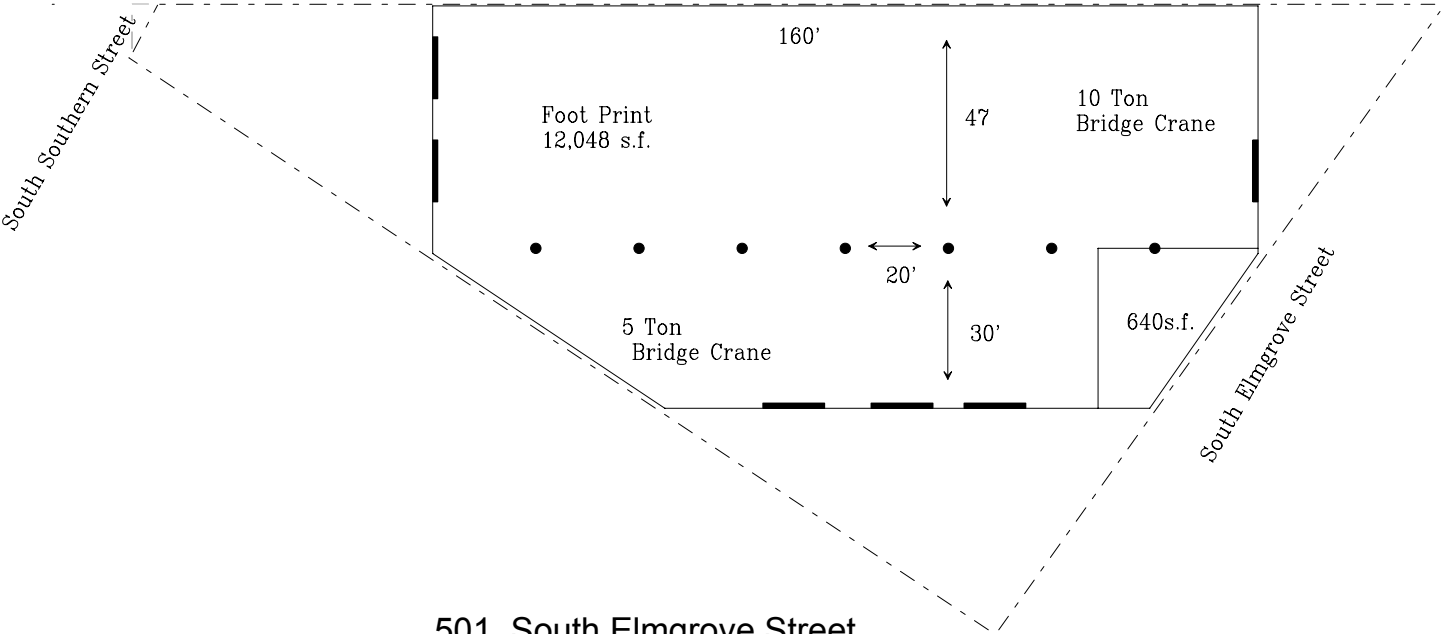

501 South Elmgrove Street
Seattle, WA